



www.regulus.eu



Pressure sensor, model 520

Installation and Operation Manual
PRESSURE SENSOR, MODEL 520
for use with IR 14 Controllers

EN

Pressure sensor, model 520

1. Introduction

The pressure sensor can be installed in heating systems in combination with IR14 controllers. It ensures reliable measurement of heating water pressure in the range of 0 to 10 bar and its subsequent evaluation by an IR14 controller.

The pressure sensor is not designed to measure drinking water pressure.

2. Technical Data

Measurement range	0 to 10 bar
Output	4 to 20 mA
Power supply	7 to 33 V DC
Connection	G ½"
Material	stainless steel
Working fluid temperature	-40 to 135 °C
Ambient temperature	-30 to 85 °C
Storage temperature	-50 to 100 °C
Overload capacity	3x
El. protection class	III
IP rating	IP 65
Consumption	< 23 mA
Reverse polarity protection	yes
Response time	< 2 ms, typ. 1 ms
Operating frequency	< 100 Hz

3. Dimensions

Dimensions of the connecting external thread:

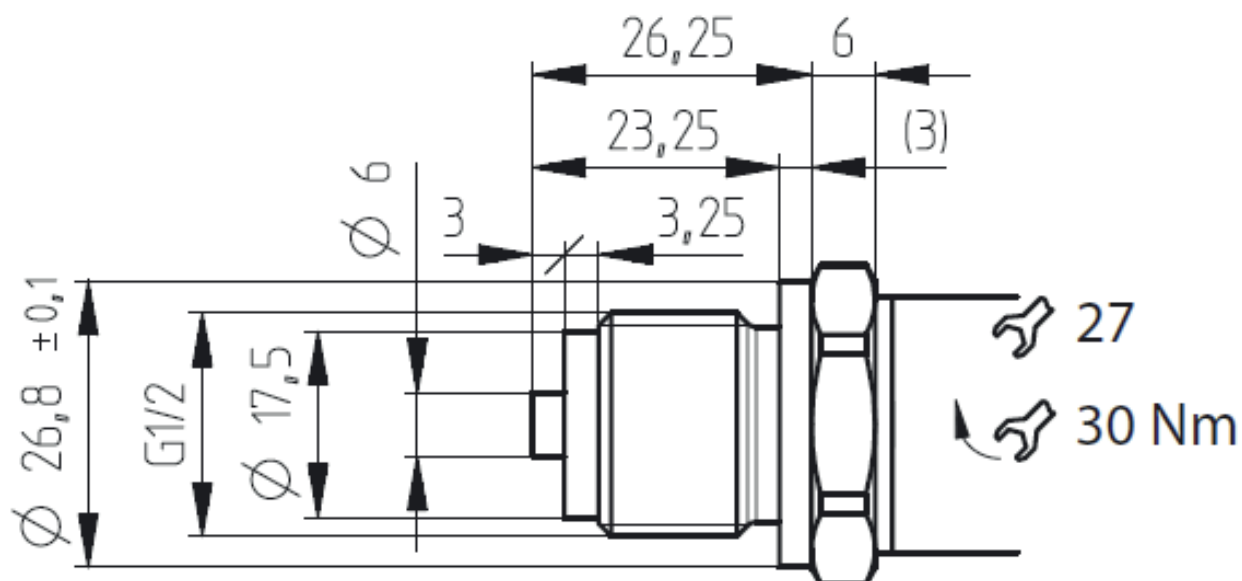

Dimensions of the sensor incl. connector:

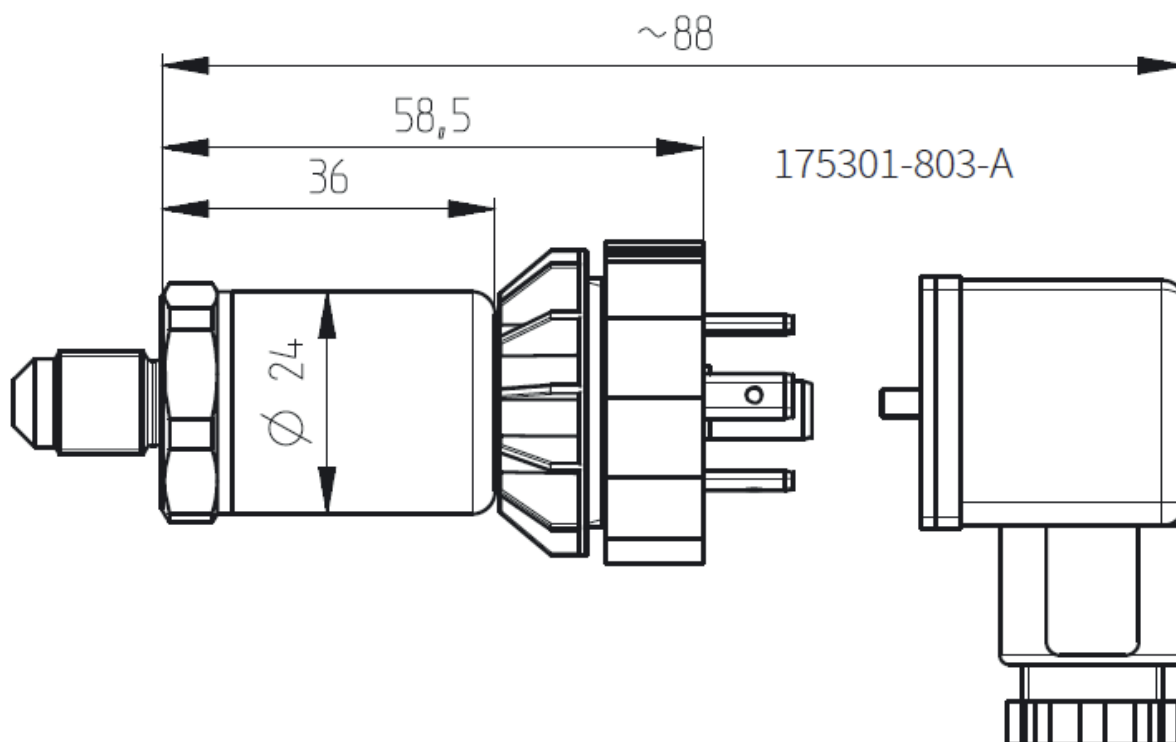

Connector DIN EN 175301-803-A with gasket is freely enclosed to the supply.

4. Wiring Diagram

