

Three-way Mixing Valves, model LK 840



Main features

Application	heating and solar systems
Description	mixing valve with rotating inner segment
Working fluid	water, antifreeze mixture for heating and solar systems and heat pumps
Installation position	any

Control

Electric control	can be fitted with electric actuators with torque of 5 Nm or more
Manual control	by turning the knob
Opening angle	90° / 360°

Technical parameters

Max. working pressure	10 bar
Max. pressure difference	5 m H ₂ O
Fluid working pressure	5 to 110 °C (120 °C in short term)
Ambient working temperat.	5 to 60 °C
Leaks	< 1 % K _{vs} at 5 m H ₂ O pressure difference

Materials

Valve body	forged brass
Valve member and spindle	brass
Inner valve bonnet	PPS
Outer valve bonnet	aluminium
Seal	EPDM

Pressure drop diagram

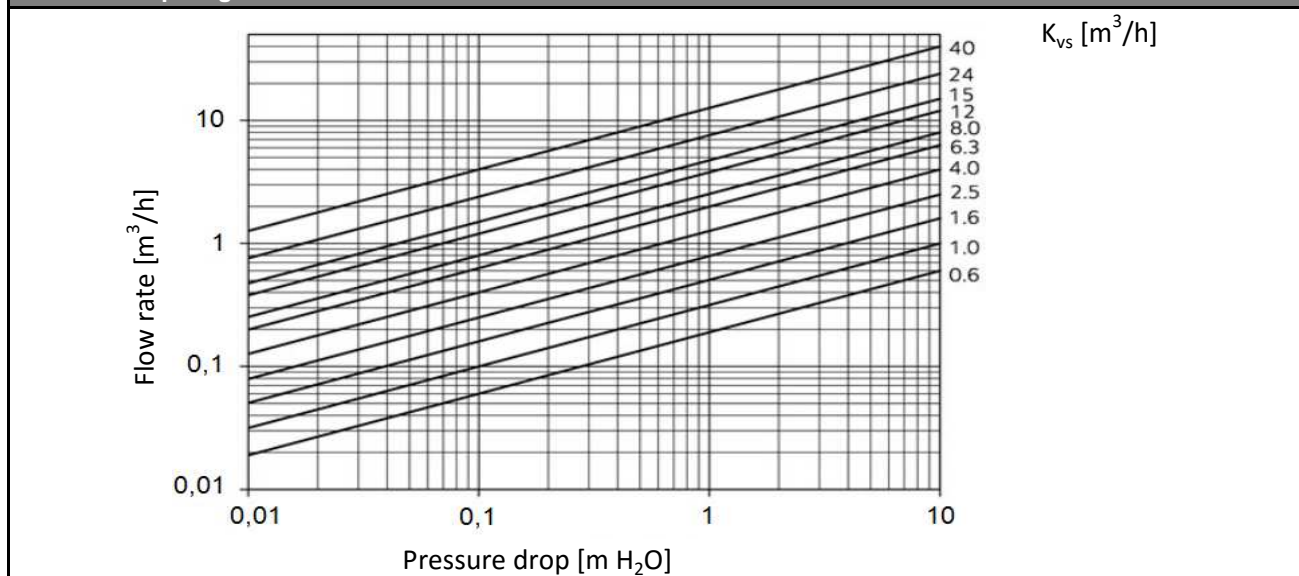

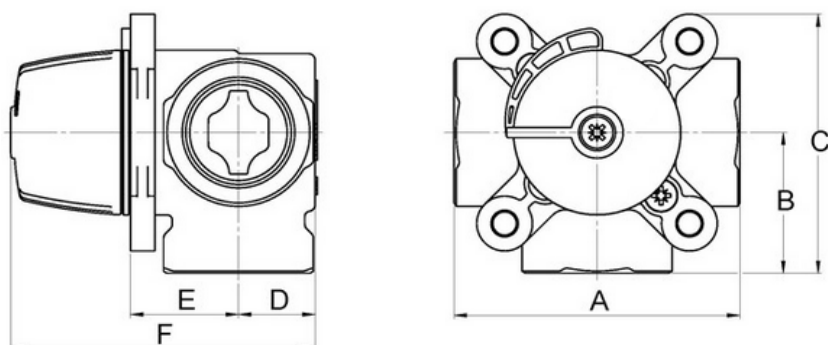
Three-way Mixing Valves, model LK 840
LK 840 with inner thread

	Code	Dimensions [mm]						Weight [kg]	K _{vs} [m ³ /h]	Connection
		A	B	C	D	E	F			
LK 840 1/2F - 1,6	13 998	80	40	75	20	28	82	0,7	1,6	G 1/2" F
LK 840 1/2F - 2,5	11 489	80	40	75	20	28	82	0,7	2,5	G 1/2" F
LK 840 3/4F - 4	14 000	80	40	75	20	28	82	0,7	4,0	G 3/4" F
LK 840 3/4F - 6,3	10 825	80	40	75	20	28	82	0,7	6,3	G 3/4" F
LK 840 1F - 6,3	14 010	82	41	76	22	31	87	0,8	6,3	G 1" F
LK 840 1F - 8	14 001	82	41	76	22	31	87	0,8	8,0	G 1" F
LK 840 1F - 12	10 630	82	41	76	22	31	87	0,8	12,0	G 1" F
LK 840 5/4F - 15	10 826	84	42	77	25	32	91	0,9	15,0	G 5/4" F
LK 840 6/4F - 24	12 276	118	59	95	30	36	100	2,1	24,0	G 6/4" F
LK 840 2F - 40	12 278	127	63,5	100	35	40	109	2,4	40,0	G 2" F

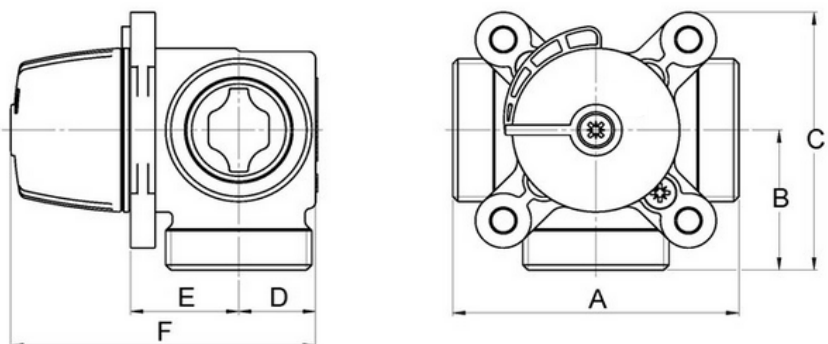
LK 840 with outer thread

	Code	Dimensions [mm]						Weight [kg]	K _{vs} [m ³ /h]	Connection
		A	B	C	D	E	F			
LK 840 3/4M - 2,5	14 822	80	40	75	20	28	82	0,7	2,5	G 3/4" M
LK 840 1M - 4	14 823	80	40	75	20	28	82	0,7	4,0	G 1" M
LK 840 1M - 6,3	14 824	80	40	75	20	28	82	0,7	6,3	G 1" M
LK 840 5/4M - 8	14 825	82	41	76	22	31	87	0,8	8,0	G 5/4" M
LK 840 5/4M - 12	14 826	82	41	76	22	31	87	0,8	12,0	G 5/4" M
LK 840 6/4M - 15	14 827	84	42	77	24	32	90	0,9	15,0	G 6/4" M
LK 840 2M - 24	14 828	124	62	98	30	36	100	2,1	24,0	G 2" M

Three-way Mixing Valves, model LK 840

LK 840 for copper pipes

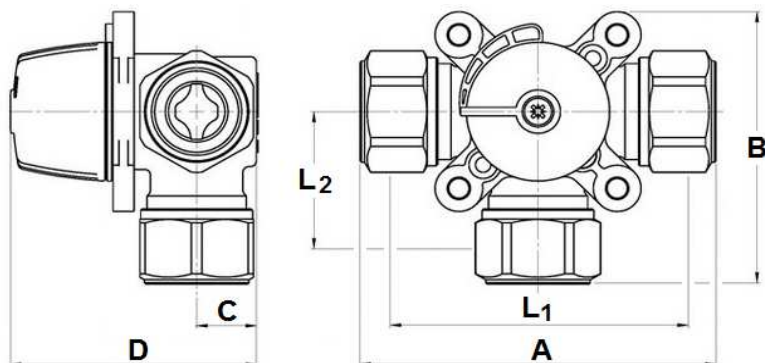
 Dimensions L₁ and L₂ correspond to dimensions of a valve without nuts.

	Code	Dimensions [mm]						Weight [kg]	K _{vs} [m ³ /h]	Connection
		A	B	C	D	L ₁	L ₂			
LK 840 Cu15 - 2,5	15 771	114	92	20	82	80	38	0,8	2,5	15 mm
LK 840 Cu18 - 2,5	15 772	114	92	20	82	80	38	0,8	2,5	18 mm
LK 840 Cu22 - 2,5	15 773	114	92	20	82	80	38	0,8	2,5	22 mm
LK 840 Cu22 - 6,3	15 774	87	78	20	82	72	35	0,8	6,3	22 mm
LK 840 Cu28 - 4,0	15 775	120	95	20	82	80	41	0,8	4,0	28 mm
LK 840 Cu28 - 6,3	15 776	120	95	20	82	82	41	0,8	6,3	28 mm