

TWO-WAY ZONE VALVES

VZK R Two-way Zone Ball Valve

Zone ball valves intended for heating or solar thermal systems with water or antifreeze fluid and for drinking water systems.

The valve is equipped with a **two-point control actuator (SPST)**. The actuator can be removed without disassembling the valve. The valve must not be installed in a position with the actuator facing down.

It can be used in connection with any controller or thermostat that has a 230 V contact to switch the switched phase of the actuator. The valve is normally closed, it opens when the switched phase is switched on. This mode can be changed to „normally open“. The opening time is 60 s. In case of failure of the controller or thermostat, the actuator can be controlled manually.



TECHNICAL DATA

MAX. WORKING PRESSURE	10 bar
MAX. PRESSURE DIFFERENCE	10 bar
FLUID WORKING TEMPERATURE	up to 110 °C

MATERIALS

VALVE HOUSING	CW617N
VALVE SPINDLE	CW617N
VALVE BALL	chrome-plated brass
O-RINGS	EPDM, FPM
POWER CABLE	PVC

ACTUATOR

POWER SUPPLY	230 V 50 Hz
MAX. CONSUMPTION	4VA
CURRENT	17 mA
IP RATING BY EN 60529	IP 42
PROTECTION CLASS BY EN 61140 ed.2	II

POWER CABLE

CROSS SECTION	3× 0.5 mm ²
LENGTH	2 m

VALVE PRESSURE DROP

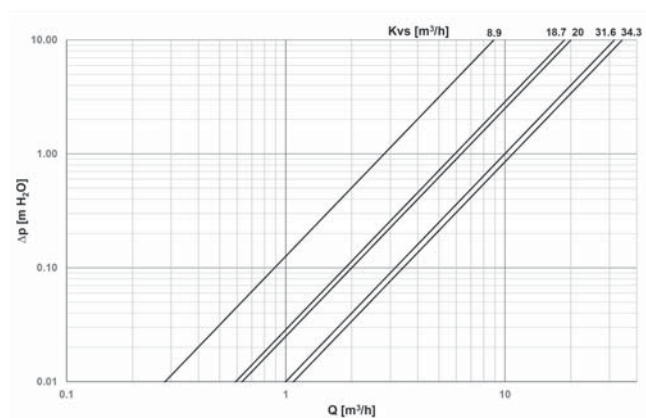

DIMENSIONS AND TYPES

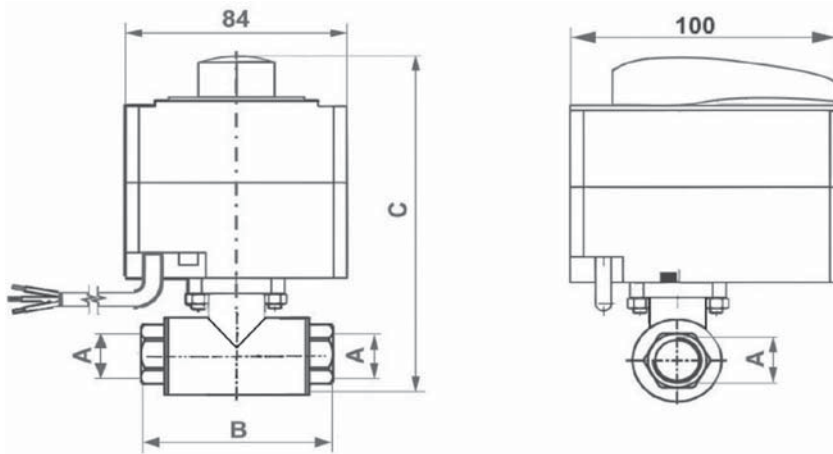

		VZK R 220 1/2F	VZK R 220 3/4F	VZK R 220 1F	VZK R 225 1F	VZK R 225 5/4F
CONNECTIONS	--	1/2" F	3/4" F	1" F	1" F	5/4" F
B	mm	96	96	96	104	104
C	mm	160	160	160	160	160
WEIGHT	kg	1.2	1.2	1.2	1.5	1.5
NOMINAL DIAMETER	DN	20	20	20	25	25
KVS	m ³ /h	8.9	18.7	20.0	31.6	34.3
CODE	--	19682	19677	19680	19686	19689

ELECTRICAL WIRING

