

Pumping station 1-way "Solar 1"



SAFETY: Please read the directions carefully before to set the unit going, in order to avoid accidents and damages in the plant caused by an incorrect use of the product. Keep this manual for future consultations.



Back plate to fasten the unit to the wall or to the cylinder.



(A) all valve on the return way (thermoter with blue ring and scale 0-120°C) with "Solar" checkball.

Solar Checkball

It is included into the ball valve. It ensures the seal and low head losses. To exclude the checkball valve, for instance in case of emptying rotate the handle by 45° clockwise.



Return

(A)

(B) Security unit

The security unit, CE and TUV approved, protects the installation from the overpressures. It is calibrated at 6 bar, over this pressure the security unit starts. It is also provided with a manometer and with a connection to the expansion vessel by a 3/4" flexible kit (optional), see here below.

(B)



(D) Circulating pump

Three speed circulating pump with manual regulation. Thanks to the seal of the ball valves before and after the circulating pump, it can be removed without emptying the installation.

(D)

Seat for the course of the cable going to the circulating pump.

(C) Flowmeter

The flowmeter allows to regulate the flow rate to the capacity of the installation, by a 3-way ball valve. If the valve is closed the usual circulation is cut off, it is possible to use the side filling tap to fill the installation.

There is also another side tap, for the draining.

The proximity of the two taps helps these operations minimizing the distance between the filling and the draining. The flow rate is measured and shown by the special sliding cursor: the measurement is immediate thanks to the proximity to the regulation valve.

(C)

As shown hereinunder four flowmeters are available with different intervals of measurement:

1-6 l/min, 2-12 l/min, 8-28 l/min and 8-38 l/min.

L/min	L/min	L/min	L/min
6	12	28	38
5	10	24	32
4	8	20	28
3	6	16	20
2	4	12	14
1	2	8	8

Epp insulation box

Measurements 150x425x150.

Box with a special bracket to fasten the unit and with the groove for the cable.

Cover with the opening for the cable press. (The cable press must be positioned towards the down, see the picture). Side opening for the security unit. A special window allows to read and to regulate the flow without removing the cover.

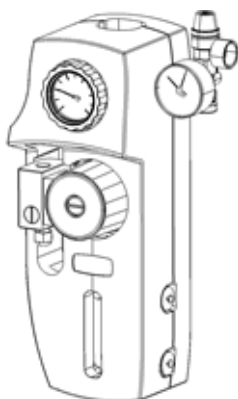
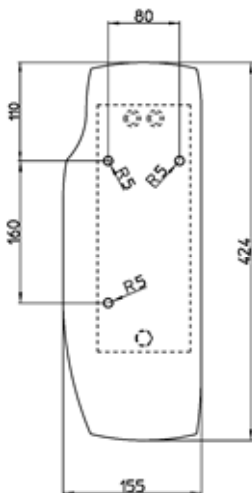

Pumping station 1-way "Solar 10"

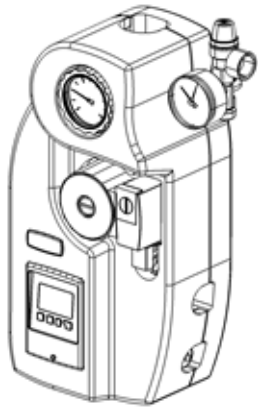

Epp insulation box

Measurements 215x440x150.

It includes a controller holder insert suitable for the course of the power supply cable and of the temperature sensor cables. Side opening on the back part of the insulation box for the security unit. Back plate to fasten the unit to the wall or to the cylinder.

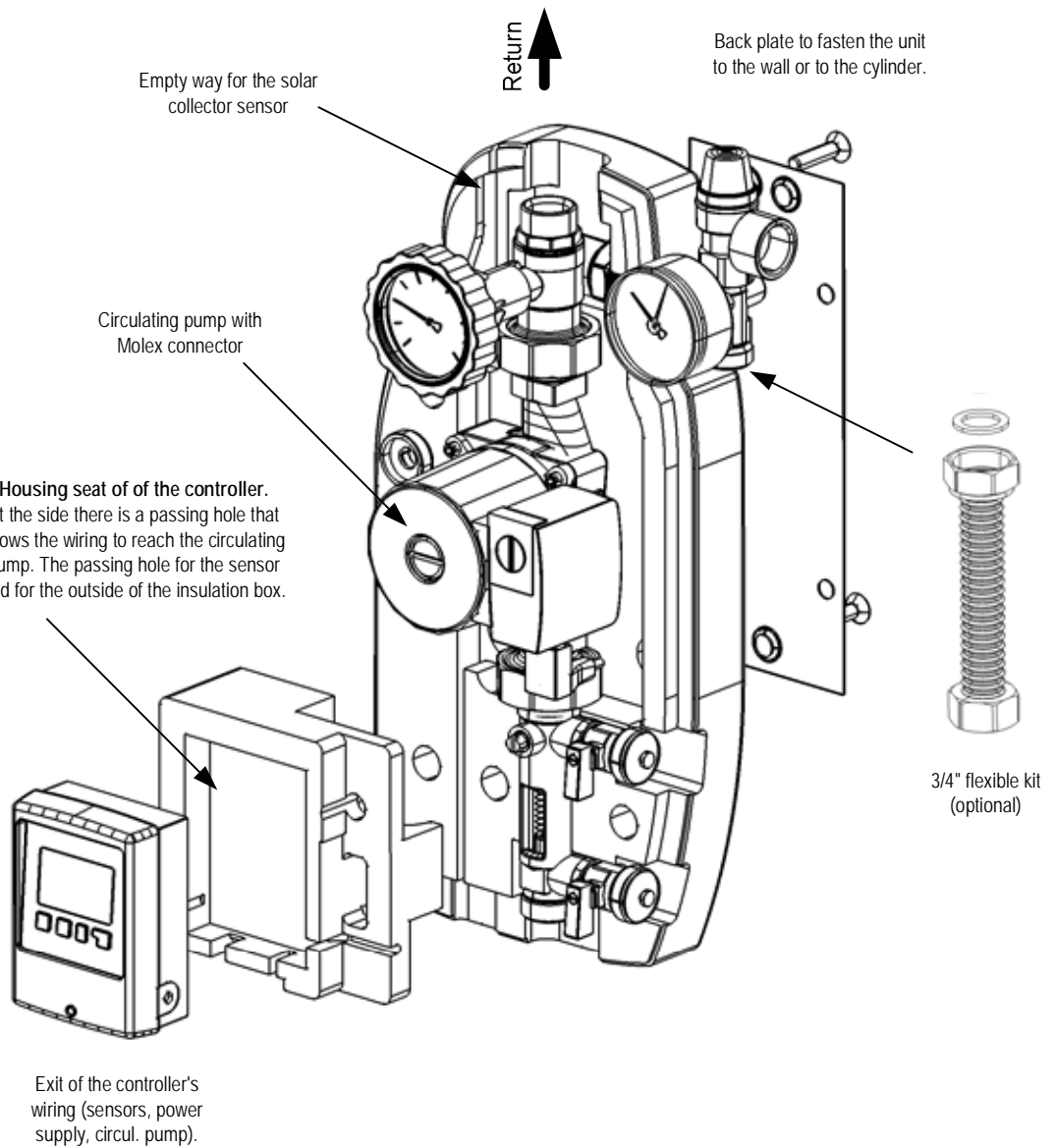
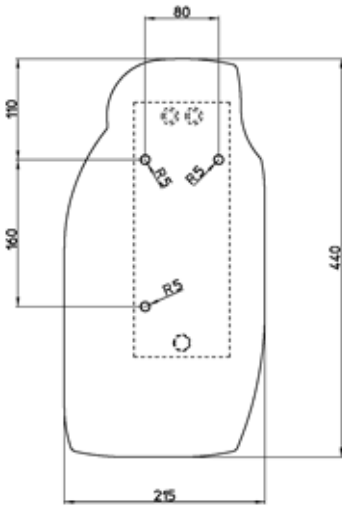

TAKE CARE: as regards the installation and the working of the controller, please look to the here enclosed manual.

Directions for the use of the flowmeter to fill the installation:

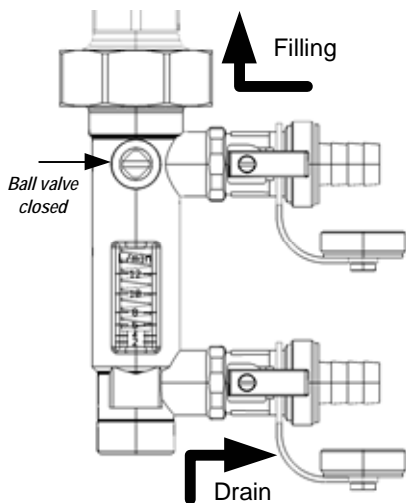

(1) - Filling the installation:
Remove the plugs from the side valves and connect the hose unions. Close the ball valve and open the side filling valve and draining valve.

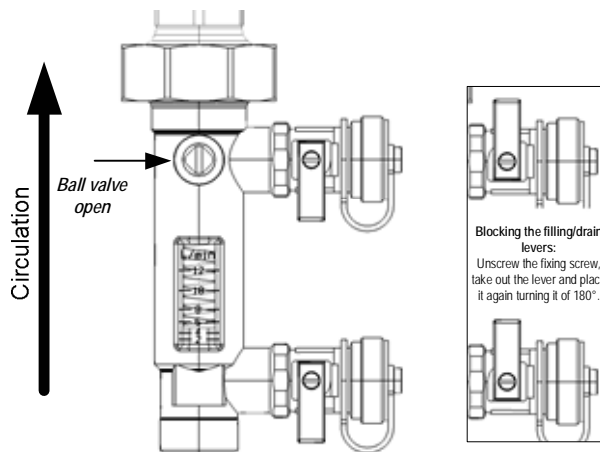

(2) - Starting the installation working:
Open the ball valve and close the side filling and draining valves. Remove the hose unions and screw again the plugs.
To avoid any casual opening of the side valves, it is better to stop the levers in the close position, as shown here aside.

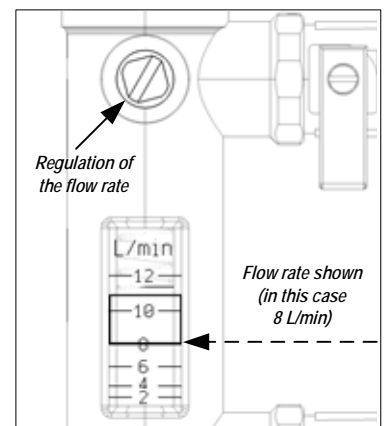

(3) - Regulate the flow rate using the regulation rod until the right flow rate is shown.

N.B. The flow rate is shown taking as reference the lower edge of the sliding cursor. (see picture)