

MECHANICAL ROOM THERMOSTATS

TP 546

Mechanical room thermostats featuring easy handling and operation without any power supply. A big dial with a clear scale enables precise temperature settings between 5 and 30°C.

TP 546 thermostats are manufactured either with contacts for control of current appliances (boilers, fans etc.), min. switched current 250 mA, or with contacts for control of electronic circuits where the switched current is between 20 and 300 mA.



TP - 546 DT - basic model, 230 V



TP - 546 LA - 230V model, with a glow lamp signaling ON state



TP - 546 OL - 230V model, with a glow lamp signaling ON state and with a switch



TP - 546 GCDT - Model for electronic circuit switching (switched current 20-300 mA)

Technical Data	DT	LA	OL	GCDT
Temperature range	5 - 30 °C	5 - 30 °C	5 - 30 °C	5 - 30 °C
Switching difference	0.4 - 0.8 °C	0.4 - 0.8 °C	0.4 - 0.8 °C	0.4 - 0.8 °C
Operation signal	no	yes	yes	no
Switch	no	no	yes	no
Operating voltage	230 V/50 Hz	230 V/50 Hz	230 V/50 Hz	24 or 230 V
Max. contact load	16(2.5) A	16(2.5) A	16(2.5) A	300 mA
Power supply to contacts	230V	230V	230V	230V
Wiring	2 conductors	3 conductors	3 conductors	2 conductors
IP protection	IP20	IP20	IP20	IP20
Relative humidity	5 - 90% (non-condensing)	5 - 90% (non-condensing)	5 - 90% (non-condensing)	5 - 90% (non-condensing)
Code	10 945	10 946	10 947	10 948

Mounting accessories

Wall frame for TP 546 room thermostat, for installation on an electrical box

Code: 11 076

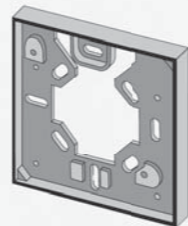

Temperature limiting pin for TP546 room thermostat

Code: 11 077

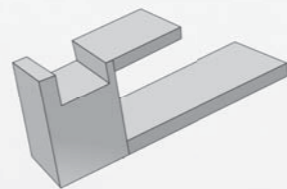

Regulus

ROOM THERMOSTATS



electronic
mechanical



Regulus

v1.4-04/2015

Regulus spol. s r.o., Czech Republic
Do Koutů 1897/3, 143 00 Praha 4
Tel.: +420 241 765 191, Fax: +420 241 763 976
E-mail: sales@regulus.eu
Web: www.regulus.eu

Energy-saving solutions

ELECTRONIC PROGRAMMABLE ROOM THERMOSTATS

Programmable electronic room thermostats with a weekly program are intended for comfort room temperature control according to a preset time schedule. Energy is thus saved and thermal comfort maintained. These thermostats are all equipped with an easy-to-read LCD display showing room temperature, time and weekday, status of the output relay (boiler ON/OFF) and the current mode (setback - comfort - antifrost). The mode can be changed simply by pressing a key.

TP 07

enables setting 4 different temperatures in 4 time sections for each weekday, the temperature difference can be selected. Heat anticipator can be switched on - heating is switched on in advance so that the required temperature is reached at the preset time. The desired temperature can be changed without changing the schedule, not only for a short time but also for a certain number of days or without a time limit.



Technical Data	TP07
Adjustable temperature range	7 - 35 °C in 0.5°C steps
Adjustable temp. difference	yes 0.5 - 1.5 °C
Reading interval	10 s
Antifrost temperature	5 °C
Number of weekly programs	1+
Programs for days	Mo, Tu, We, Th, Fr, Sa, Su
Number of possible changes per day	4 in 15min. steps
Max. contact load	24 - 230VAC; 5(2)A
Power supply	2x battery AA 1.5V
IP protection	IP30
Code	8 180

Max. current is given for resistance load, the number in brackets is valid for induction load.

TP 08

offers a selection from eight preset programs incl. the antifrost one, or creating further eight user defined programs. 2 temperature levels (set-back or comfort) can be set in the range from 5°C to 35°C. The time program is shown on the display.



Technical Data	TP08
Adjustable temperature range	5 - 35 °C in 0.5°C steps
Adjustable temp. difference	no
Reading interval	10 s
Antifrost temperature	5 °C
Number of weekly programs	7+ 8+ antifrost
Programs for days	Mo, Tu, We, Th, Fr, Sa, Su
Number of possible changes per day	24 in 1hour steps
Max. contact load	24 - 230VAC; 8(2)A
Power supply	2x battery AA 1.5V
IP protection	IP30
Code	6 298

Max. current is given for resistance load, the number in brackets is valid for induction load.

ELECTRONIC ROOM THERMOSTATS

TP 18

A simple electronic room thermostat with an LCD display, showing the room temperature and the current state (ON/OFF). Battery powered, 2x AAA.

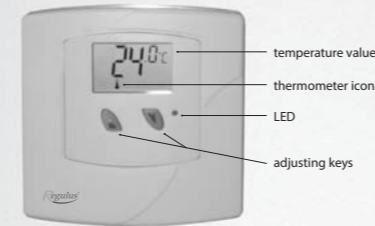

Technical Data	TP18
Temperature range	5 - 35 °C adjustable
Switching difference	~ 0.5 °C
Operating voltage	24 - 230 V
Max. contact load	5(3.5)A
Power supply to contacts	2 x 1.5 V AAA
IP protection	IP 30
Relative humidity	5 - 90% (non-condensing)
Code	7355

TP 39 a TP 69

A simple electronic room thermostat with an LCD display, showing the room temperature and the current state (ON/OFF). Mains powered (230 V), no batteries needed. TP 39 is controlled by a dial, TP 69 by keys.



Technical Data	TP39	TP 69
Temperature range	5 - 35 °C adjustable	5 - 35 °C adjustable
Switching difference	~ 0.5 °C	~ 0.5 °C
Operating voltage	230 V /50 Hz	230 V /50 Hz
Max. contact load	16(3) A	16(3) A
Power supply to contacts	230 V	230 V
IP protection	IP 20	IP 20
Relative humidity	5 - 90% (non-condensing)	5 - 90% (non-condensing)
Code	6299	11583

TZ 33

A plug-in electronic thermostat with an LCD showing room temperature and the thermostat's ON/OFF state. The LED below the display indicates the plug state (ON/OFF). Mains powered (230 V), no batteries needed.



Technical Data	TZ33
Temperature range	5 - 35 °C adjustable
Switching difference	~ 0.5 °C
Operating voltage	230 V /50 Hz
Max. contact load	16(3) A
Power supply to contacts	230 V
IP protection	IP 20
Relative humidity	5 - 90% (non-condensing)
Code	6 295

TZT 63

A plug-in electronic thermostat with a timer and antifrost protection. The timer enables to override the preset temperature by simple pressing a key and to switch the controller on for a preset time between 15 min. and 5 hours. After expiration it returns to the thermostat mode. An easy-to-read LCD displays ambient temperature, thermostat state (ON/OFF) or the countdown timer. It is mains powered (230 V), no batteries needed.



Technical Data	TZT63
Temperature range	5 - 35 °C adjustable
Switching difference	~ 0.5 °C
Operating voltage	230 V /50 Hz
Max. contact load	16(3) A
Power supply to contacts	230 V
IP protection	IP 20
Relative humidity	5 - 95% (non-condensing)
Code	8 269