

Angle Ball Valve for Gas, typ 1230

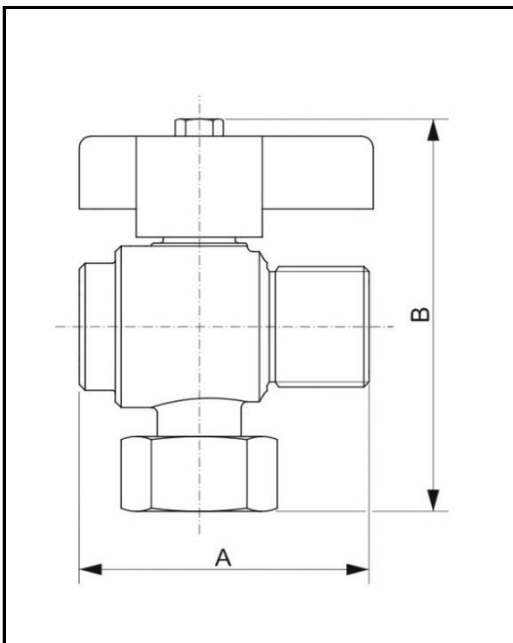

Application	intended to close or open complete the flow of medium
Medium	flammable gases
Control	manual, by turning butterfly handle
Valve working angle	90°
Valve	
Max. working overpressure	MOP 5 by EN 331 (5 bar)
Working temperature range	-20 to 60 °C



Model	1230 - 1/2"	1230 - 1/2"x3/4"	1230 - 3/4"
Connection	1/2" M/F (nut)	1/2" M x 3/4" F (nut)	3/4" M/F (nut)
DN	10	15	15
A	49 mm	51 mm	51 mm
B	68 mm	70 mm	70 mm
Weight	170 g	225 g	240 g
Code	14 817	14 840	14 816
Materials			
Valve housing	brass (CW617N), nickel-plated		
Floating ball, spindle	brass (CW614N), chrome-plated		
Ball seal	PTFE		
O-ring	NBR		
Butterfly	aluminium alloy		