

Straight Ball Valve for Gas, types 740 and 745

model 740



model 745/F



model 740/FE



model 745/FE



Application	intended to close or open complete the flow of medium
Medium	flammable gases
Control	manual, by turning lever or butterfly handle
Valve working angle	90°
Valve	
Max. working overpressure	MOP 5-20 by EN 331 (20 bar)
Working temperature range	-20 to 60 °C
Materials	
Valve housing	brass (CW617N), nickel-plated
Floating ball	brass (CW614N), chrome-plated
Spindle	brass (CW614N), chrome-plated
Ball seal	PTFE
Spindle seal	VITON
Lever / butterfly	steel / aluminium

Straight Ball Valve for Gas, types 740 and 745

model 740

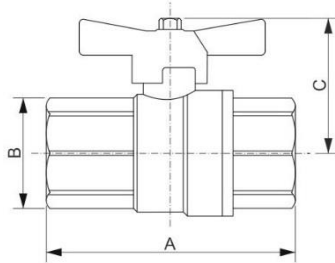

model 745/F

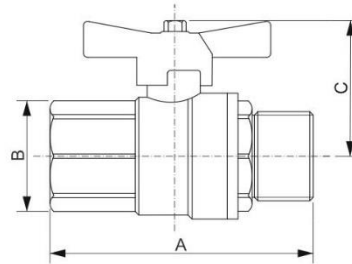

model 740/FE

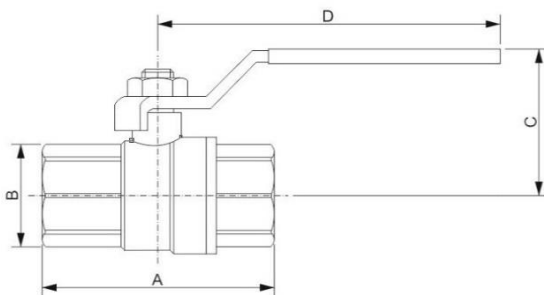

model 745/FE

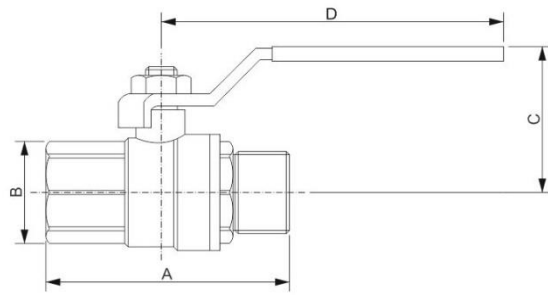

Model	Connection	DN	Dimensions				Weight	Code
			A	B	C	D		
740 - 1/2" FF	1/2" F/F	15	59 mm	26 mm	37 mm	-	190 g	14 774
740 - 3/4" FF	3/4" F/F	20	67 mm	32 mm	41 mm	-	300 g	14 776
740 - 1" FF	1" F/F	25	78 mm	40 mm	46 mm	-	505 g	14 777
740/FE - 1/2" FF	1/2" F/F	15	59 mm	26 mm	42 mm	85 mm	210 g	14 778
740/FE - 3/4" FF	3/4" F/F	20	67 mm	32 mm	46 mm	85 mm	320 g	14 779
740/FE - 1" FF	1" F/F	25	78 mm	40 mm	52 mm	105 mm	540 g	14 780
745/F - 1/2" MF	1/2" M/F	15	67 mm	26 mm	37 mm	-	200 g	14 782
745/F - 3/4" MF	3/4" M/F	20	74 mm	32 mm	41 mm	-	300 g	14 783
745/F - 1" MF	1" M/F	25	86 mm	40 mm	46 mm	-	510 g	14 784
745/FE - 1/2" MF	1/2" M/F	15	67 mm	26 mm	42 mm	85 mm	220 g	14 785
745/FE - 3/4" MF	3/4" M/F	20	74 mm	32 mm	46 mm	85 mm	320 g	14 786
745/FE - 1" MF	1" M/F	25	86 mm	40 mm	52 mm	105 mm	540 g	14 787